

ORIGINAL

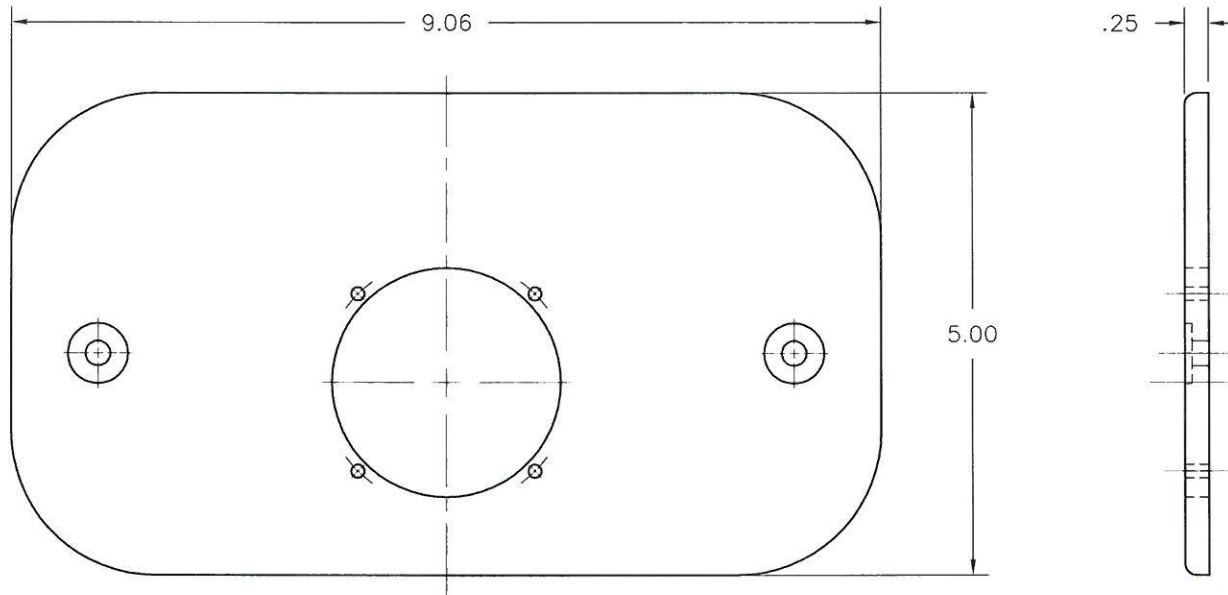

Finish:

- PC-B Black Powder Coat
Cardinal #T002-BK08
- PC-G Traffic Green Powder Coat
Cardinal #T007-GN16
- PC-Y Yellow Powder Coat
Cardinal #T009-YL71

ALL DIMENSIONS ARE FOR REFERENCE ONLY

Notes:

1. Chem Film per Polara drawing PBAP9X12-CFI before powdercoat.
2. Plug all threaded holes.

01-14-09	C	22543	BM							
Change PC-Y Yellow Powder Coat Cardinal #T009-YL14 to Cardinal #T009-YL71.										
11-04-02	B	21882	BB	CLM	LB	WR	MVW	JMc	JMc	
08-09-01	A	21768	BB	CLM	LB	WR	FB	RVC	WH	
REV.	DATE	LTR	E.C.O. NO.	BY	CKR	E.M.	ENG	MFG	QA	FNL

POLARA ENGINEERING INC. 9153 STELLAR COURT, CORONA, CA. 92883				
TOLERANCES: .XXX ±.005 .XX ±.02 (EXCEPT AS NOTED)				SCALE 1:2
DRAWN BY BB	CKR. CLM	ENG. MGR. LB	MFG. MGR. FB	SHEET 1 OF 1
DATE 08-11-00	DSN. ENG. WR	Q.A. APP. RVC	FINAL APP. JMc	USE
TITLE 9 X 12 PUSH BUTTON ADAPTER PLATE POWDER COATED			DWG. NO. PBAP9X12-PC-X	

INFORMATION ON THIS DOCUMENT IS PROPRIETARY TO POLARA AND SHALL NOT BE USED, COPIED, REPRODUCED OR DISCLOSED IN WHOLE OR IN PART WITHOUT WRITTEN CONSENT OF POLARA. POLARA RESERVES THE RIGHT TO MAKE CHANGES TO FEATURES, SPECIFICATIONS AND INFORMATION HEREIN WITHOUT NOTICE.

304-250 Rev. A22545 12/17/08 *gmc*